

Introduction to KLM Health Services

January 31, 2024

 **KLM** Health Services



● Our story

For more than 25 years, KLM Health Services has helped employees to live, work and travel in good health. We do our utmost to ensure that they can excel at what they do and expand their horizons each and every day.

We are expert consultants in our field and our specific areas of expertise are at the cutting-edge of health, work and travel. From first-aid care and medical support to vaccinations, medical examinations and lifestyle programs. What's more, our customers are exceptional. They generally operate internationally, work irregular hours or have to deal with specific safety risks. This presents extra challenges in terms of biorhythms, sleep, safety and health.

KLM Health Services. **Fit** to explore your world.

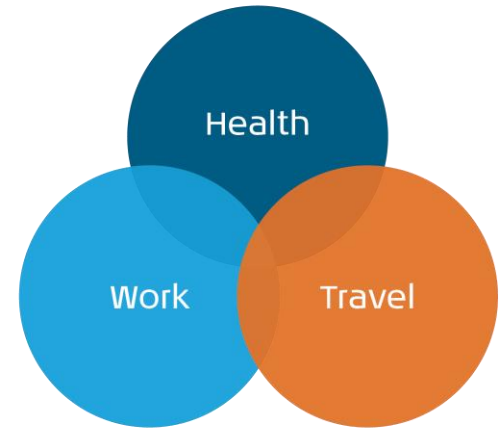

International



Irregular working
hours



Security risks

- **Our organization**



Services and solutions.

● Services and solutions

- Executive Preventative Medical Examinations
- Preventive Health Care Advice and examinations (individual and group)
- Vaccinations, Travel Advice, Medical Visa Documentation
- Professional 24/7 Medical Network
- Medication Supply and Medical Transport (Pharmacy Schiphol Airport)
- Occupational health
- And more...



International Health and Travel Services





Airport Medical Services

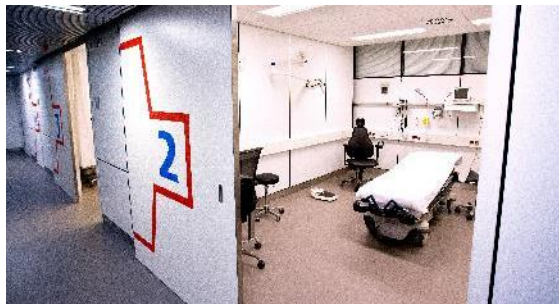

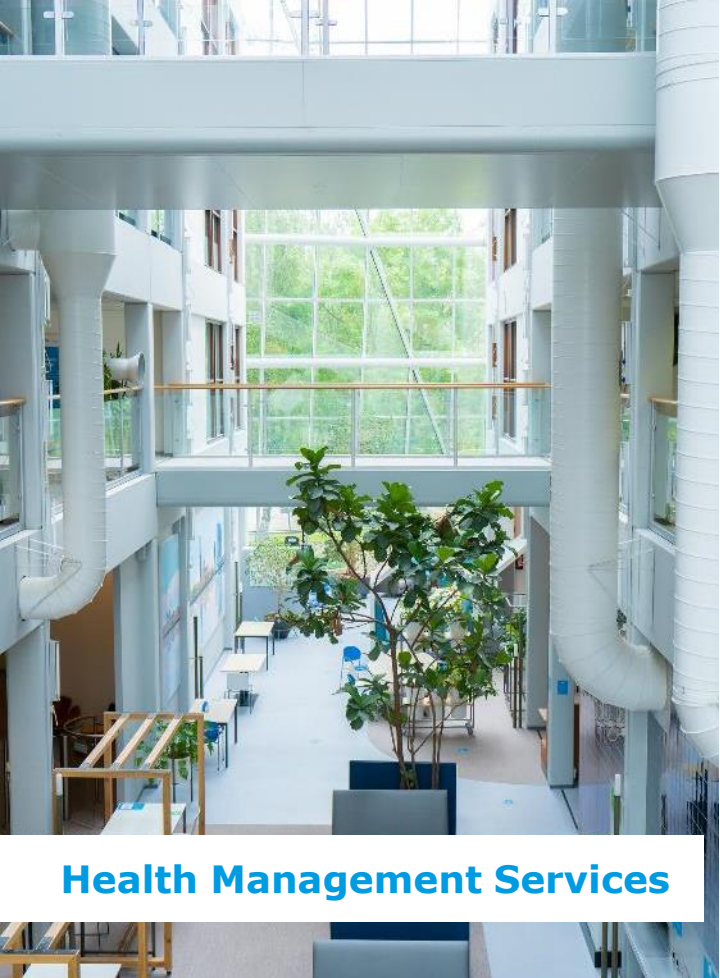



Executive Health Management



New partnership with JSIS.

● Health screening

- The screening is a medical examination that examines whether the employee's lifestyle is in line with the requirements for good health and whether there are any health risks.
- The screening will take from 1 hour to 1,5 hour depending on the number of required examinations.
- Basic examinations: - Medical History, Clinical examination, BMI, Blood pressure, Blood tests, Urine tests.
- After your visit you will receive a digital personal medical report. This is only shared with the participant.
- If there are any abnormalities, we will refer you to your GP who can assist to arrange a referral to a specialist.

Locations and making an appointment .

- **Make an appointment**

An appointment can be made with the secretariat of the Medical Examination Centre from Monday to Friday.

Opening times from: 08.30 and 17.00 hour

Please mention which screening you have been invited to.

Appointments will be confirmed by e-mail. A link to fill in the health questionnaire will also be sent by email.

Contact details:

Phone: +31 (0)20 - 6493072

E-mail: moc.health@klm.com

● Locations in the Netherlands

KLM Health Services
Stationsplein N.O. 236
Building 133
1117 CJ Schiphol-Oost



We have sufficient parking at Schiphol-Oost. We have a special parking facility directly next to building 133 where people can park for free when they come for the inspection. This location is also easily accessible by public transport.

KLM Health Services
Hofweg 9
(t.o. Binnenhof)
2511 AA Den Haag (The Hague)



'Paid parking' applies everywhere in the center of The Hague. There are several parking garages in the immediate vicinity of the visiting address. We advise you to use this (for example the Spuigarage). This location is also easily accessible by public transport.

For more information, please visit our website
www.klmhealthservices.com
or contact
sales.health@klm.com

